

46—540 Removal and installation of track rod

Data

Part No.	Length "a"	Remarks
115 330 07 03	342 ± 2	Lefthand threads mounted left seen in driving direction

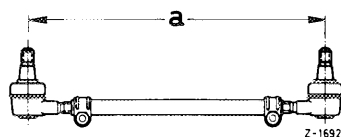

Approved grease types for ball joints

Multi-purpose grease	refer to Specifications for service products page 267
----------------------	---

Tightening torques	Nm	(kpm)
Castle nut for attaching track rod to steering arms	35	(3.5)
Hex screw to clamp of track rod	20	(2)

Special tools

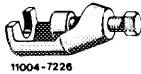
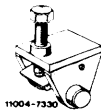
Puller for ball joint of track rod on pitman arm, intermediate steering arm and steering knuckle arm		136 589 12 33 00 or 186 589 10 33 00
Puller for ball joint of track rod on pitman arm and intermediate steering arm		111 589 08 33 00

Self-made tools

Assembly sleeve for flat-wire clamping ring	refer to illustration item 8
Assembly sleeve for plastic ring	refer to illustration item 7

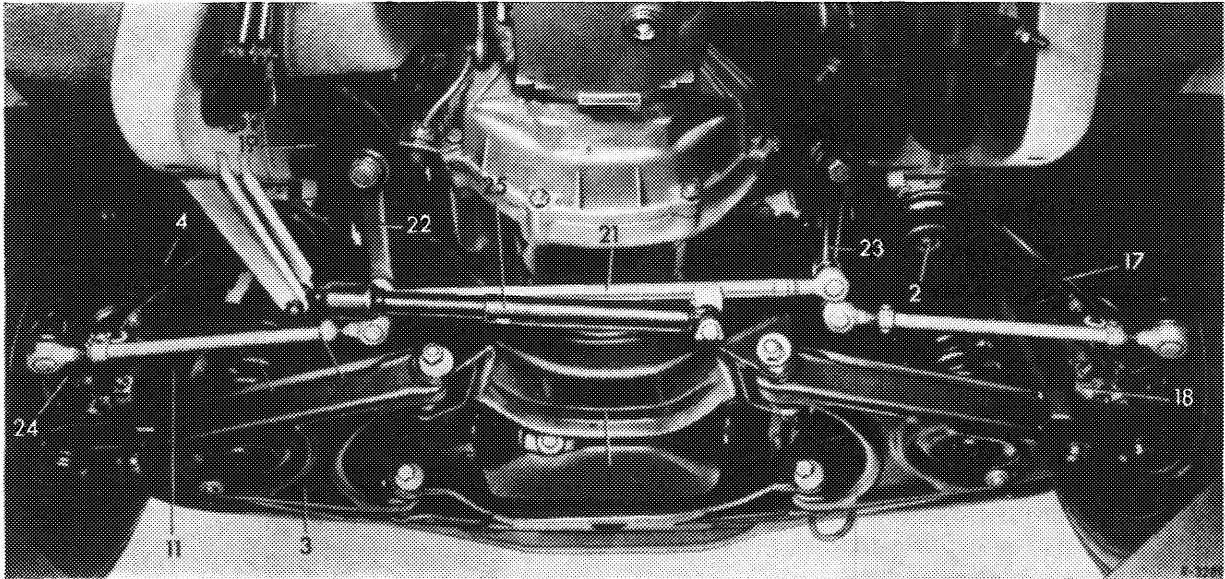

- | | | |
|----------------------|------------------------|------------------------------|
| 1 Front axle carrier | 11 Front shockabsorber | 21 Drag link |
| 2 Rubber mount | 17 Brake hose | 22 Pitman arm |
| 3 Lower control arm | 18 Caliper | 23 Intermediate steering arm |
| 4 Upper control arm | 19 Steering | 24 Steering knuckle arm |
| 10 Front spring | 20 Track rod | 25 Steering shockabsorber |

Removal

- 1 Unscrew castle nuts on joints of track rod (20) after removal of cotter pins.
- 2 Force track rod from steering arms with puller (36).

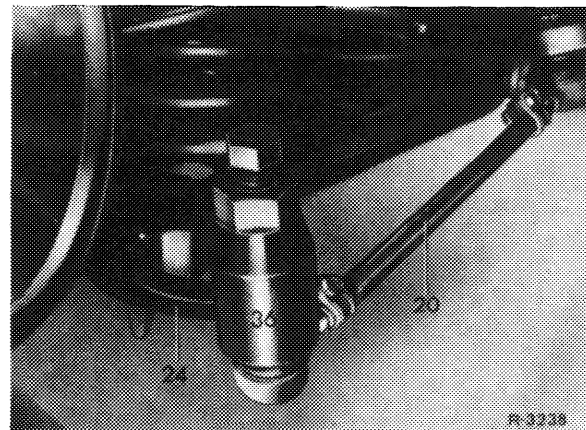

Checkup

3 Check joints of track rod. If track rods are moving too easily or are subject to play, replace respective track rod head.

4 Check rubber sleeves (2) for joints. **If a used joint has a damaged rubber sleeve, completely replace respective joint.**

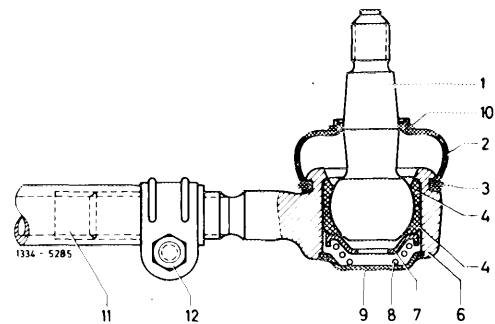

5 If the rubber sleeve (2) has been damaged when removing track rod, replacement of rubber sleeve will be enough. For this purpose, remove flat-wire clamping ring (3) and pull off sleeve including plastic fastening ring (10).

6 Prior to mounting new rubber sleeve, fill space between sleeve and joint with specified grease.

7 Mount rubber sleeve (2) and then assembly sleeve (20) on ball pin. Insert plastic fastening ring (10) over assembly sleeve into rubber sleeve.

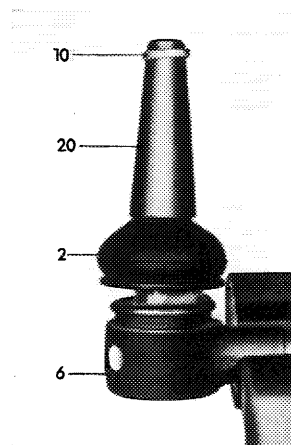

8 Place assembly sleeve (21) on ball joint and over rubber sleeve (2) and insert flat-wire clamping ring (3).

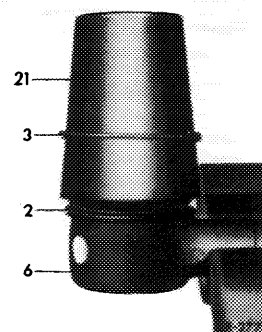

Note: Assembly sleeves are self-made according to specified dimensions.

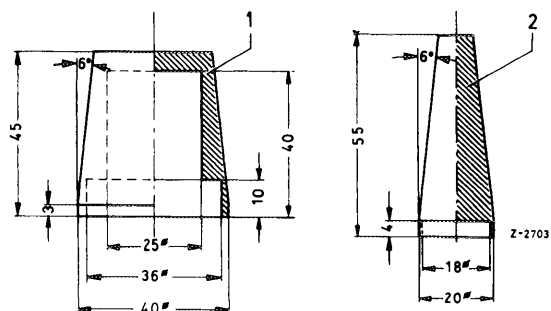

- 1 Assembly sleeve for flat-wire clamping ring
- 2 Assembly sleeve for plastic ring

Note: Maintenance-free joints are provided with grease for life. On these joints, the seal which prevents the entry of dirt is of decisive importance for the life of the joint. A damaged rubber sleeve should therefore be immediately replaced, since otherwise the penetrating dirt may result in wear of joints. For this reason, make sure that the joints are carefully checked at regular intervals.

Installation

9 Clean ball pins as well as conical seat in steering arms perfectly from grease. Then force ball pin tightly into cone of steering arm. **Screw-on castle nut** and tighten. Tightening torque 35 Nm (3.5 kpm) – reference value. Cotter castle nut.

10 Check wheel adjustment on front axle (40–320).

