

Removal

1 Disconnect spring (4) on compensating lever (5). Turn adjusting screw (8) of turnbuckle (7) completely back. Disconnect intermediate lever (6) on mounting of frame floor (10) and remove from turnbuckle.

2 Loosen brake cable control on intermediate lever (6), while pulling cotter pin from shoulder bolt and remove shoulder bolt.

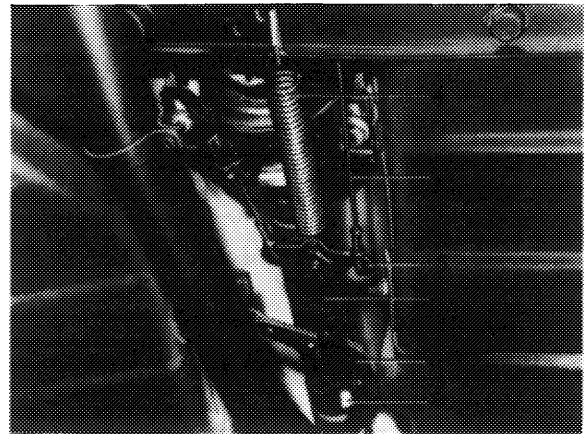

- 4 Return spring
- 5 Compensating lever
- 6 Intermediate lever
- 7 Turnbuckle
- 8 Adjusting screw
- 9 Guide on frame floor
- 10 Mounting on frame floor
- 12 Rear brake cable control
- 13 Spring clamp
- 15 Rubber grommet

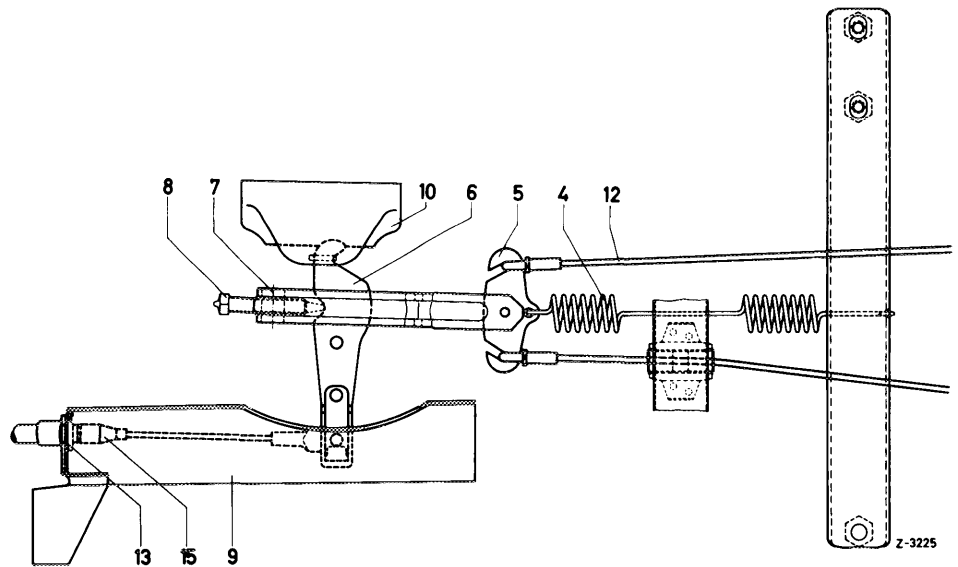

Z-3225

3 Remove spring clip (13) from cable control, remove both fastening clamps (1) from underbody.

4 Disconnect brake cable control (17) from pedal link. Remove spring clip from cable control, remove brake cable control from pedal assembly.

5 Pull brake cable control (2) from underbody in downward direction.

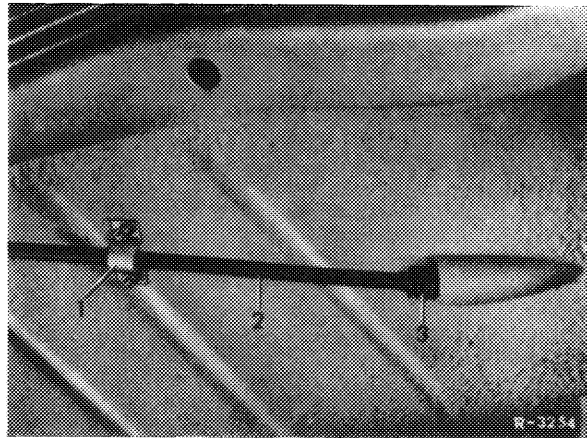

- 1 Carrier
- 2 Switch for warning light
- 3 Restoring spring
- 4 Release lever
- 5 Pull rod
- 6 Nut on rosette
- 7 Rosette
- 8 Stop washer
- 9 Actuating knob
- 10 Locking ring
- 11 Instrument panel
- 12 Cross member
- 13 Hex. bolt with washer
- 14 Detent
- 15 Pedal
- 16 Stop buffer
- 17 Brake cable control
- 18 Front end
- 19 Hex. nut with washer and snap ring

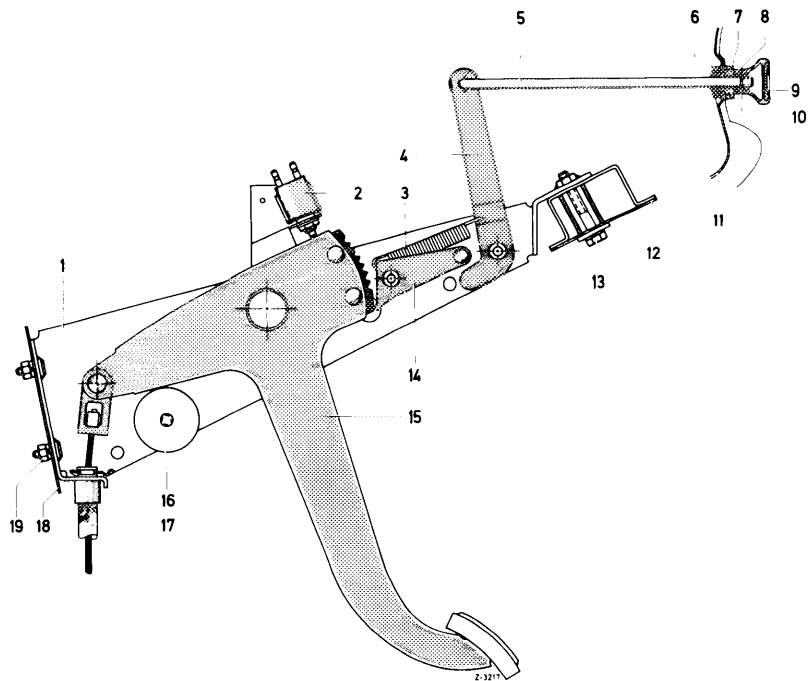

Installation

6 Introduce brake cable control (2) from below through underbody and mount rubber grommet (3). Attach pipe clamps (1) to underbody.

7 Attach brake cable control to pedal link and insert spring clip.

8 Introduce cable into guide on frame floor and insert spring clip.

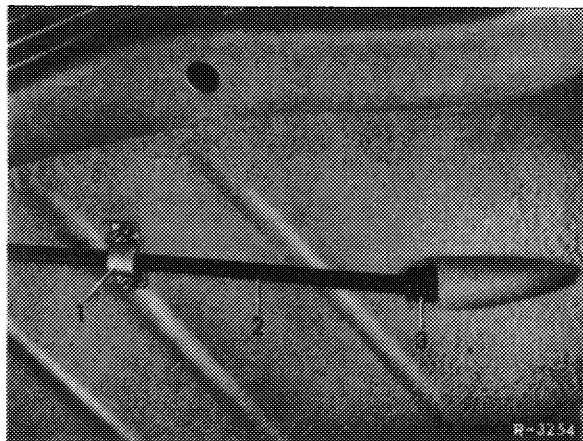

9 Attach brake cable control to intermediate lever (6).

10 Introduce intermediate lever (6) into adjusting bracket (7). Then connect intermediate lever to mounting of underbody.

11 Connect spring (4) to compensating lever (5).

12 Adjust parking brake (42–540).

