

Data

Front wheel hub	Model	114, 115 1st version <sup>1)</sup> <sup>3)</sup>	114, 115 2nd version <sup>2)</sup> <sup>3)</sup>
Bolthole circle dia. "k" for attachment of brake disc		88.5	104
Bolthole circle dia. "l" for attachment of disc wheel		112	
Flange distance "i"		73	75
Fitting "f" for brake disc		$\frac{69.50}{69.47}$	$\frac{79.97}{80.00}$
Permissible lateral play at the flange		0.03	
Permissible vertical play at the disc wheel centre "d"		0.05	
Fitting "h" for radial sealing ring		62 H8	

<sup>1)</sup> Standard equipment on models 114, 115 until June 1971.

<sup>2)</sup> For models 114, 115 standard equipment from July 1971. Replacement for 1st version.

<sup>3)</sup> Front wheel hubs with the same flange distance on the left and right should be installed on one and the same vehicle if possible.

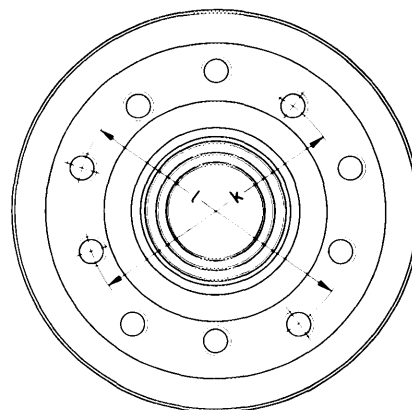
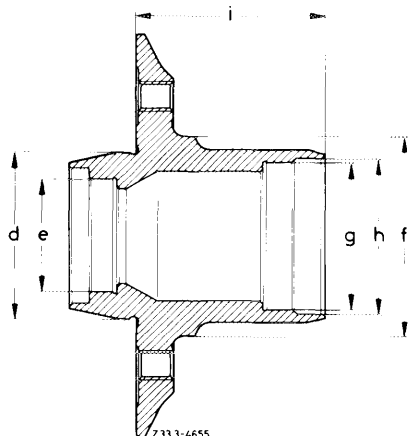

Front wheel hub  
1st and 2nd version

Designation	Identification	Part no.	Remarks
<b>Tapered roller bearings<sup>1)</sup></b>			
Inner tapered roller bearing "g"	LM 670 48/10	000 981 58 05	—
Outer tapered roller bearing "e"	LM 119 49/10	000 981 59 05	—

#### Radial sealing ring

For front wheel hub	46 x 62 x 10/8	005 997 50 46	Radial sealing ring with sealing lip and additional dust lip. During assembly, fill space between sealing lip and dust lip with specified grease.
---------------------	----------------	---------------	---

<sup>1)</sup> The bearing inner races are mounted on wheel spindle at a sliding fit or a light force fit. In the event of repairs, a radial play of 0.03 mm on inner bearing and of 0.025 mm on outer bearing between bearing inner race and wheel spindle is still permitted. If the play is larger, there is a possibility to eliminate this play during assembly by applying "Omnifit Type 80 red M or H" with activator (combination pack part no. 002 989 69 71) or Loctite 640 (part no. 002 989 20 71). For details, refer to respective instructions.

<sup>2)</sup> Special version of tapered roller bearings. In the event of repairs, pay attention to part no.

#### Lubricant

Quantity	Total capacity	approx. 70 g	Suitably, weigh full capacity prior to starting assembly of front wheel hub.
	In hub with bearing	approx. 50 g	Fill roller cages or tapered roller bearings well with grease. Also provide grease for roller faces.
	In wheel cap	approx. 20 g	Fill approx. up to edge of bead.
Series fillup:	Anti-friction bearing grease (refer to Specifications for service products page 265)		
Series fillup:	High-temperature anti-friction bearing grease (refer to Specifications for service products page 265.1) <sup>1)</sup>		

<sup>1)</sup> Available in 150 gr. screw cans, part no. 000 989 49 51.

#### Special tools

Fixture for pressing on the outer bearing races and the radial sealing ring	201 589 01 43 00
Puller for outer bearing race of inner tapered roller bearing	201 589 00 33 00
Removal punch for outer bearing race of outer tapered roller bearing	116 589 04 15 00
Holder for dial gauge to adjust wheel bearing end play	363 589 02 21 00

## Conventional Tools

Dial gauge A 1 DIN 878

e.g. Messrs. Mahr, D-7300 Esslingen  
order No. 311 000

## Note

In the event of repairs, from now on use exclusively high-temperature anti-friction bearing grease for front wheel hubs. Generally renew complete grease charge of front wheel hub, since a mixture of anti-friction bearing grease or multi-grade grease must be absolutely prevented. If, in exceptional cases, high-temperature anti-friction bearing grease is not available, multi-grade grease (refer to Specifications for service products, page 267) may be used.

## Disassembly

- 1 Remove inner race and roller cage of outer tapered roller bearing from the hub.
- 2 Remove radial sealing ring and take inner race and roller cage of inner tapered roller bearing out of the hub.
- 3 Remove the outer race of the inner tapered roller bearing using the puller.

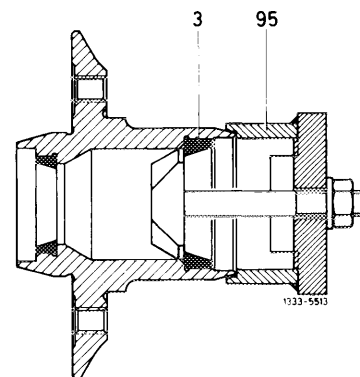

3 Outer race of inner tapered roller bearing  
95 Puller

- 4 Push the outer race of the outer tapered roller bearing out of the hub using the removal punch.
- 5 Separate front wheel hub from the brake disc (42-220).

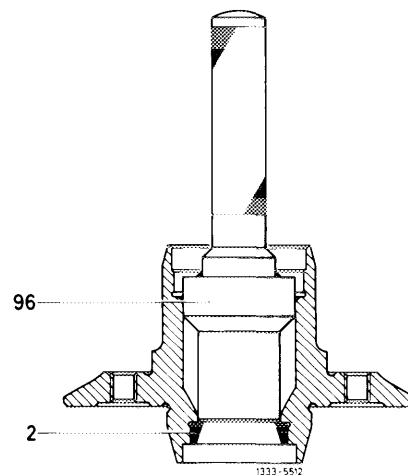

2 Outer race of outer tapered roller bearing  
96 Removal punch

## Inspection and repair

- 6 Check flange of front wheel hub for runout (see data).
- 7 Check the threaded holes for the wheel mounting.
- 8 Check tapered roller bearings and bearing seats in the hub.
- 9 Check and if necessary replace the disc (8d) which is ground on both sides.

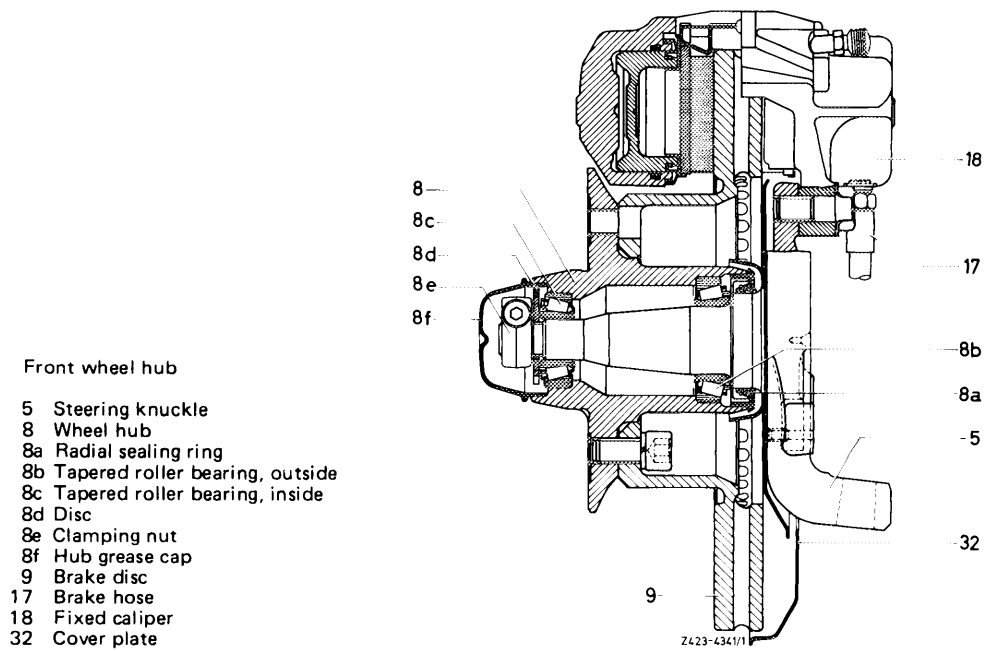

## Assembly

10 Using the special tool, press the outer races of the tapered roller bearings into the front wheel hub individually.

- 1a Pressure plate for outer race of outer tapered roller bearing
- 1b Pressure plate for outer race of inner tapered roller bearing
- 1d Bolt with washer and hex. nut
- 2 Outer race for outer tapered roller bearing

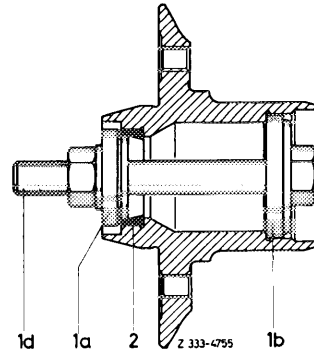

- 1b Pressure plate for outer race of inner tapered roller bearing
- 3 Outer race of inner tapered roller bearing

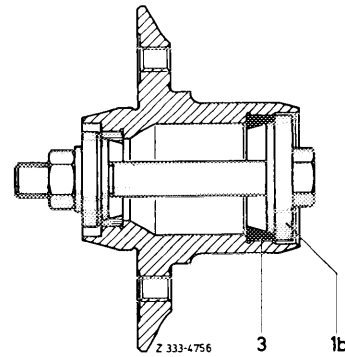

11 Fill hub cap with specified grease approx. up to edge of bead.

12 Fill roller cage of inner tapered roller bearing well with grease, insert inner race with roller cage into the hub and apply grease to the roller faces.

13 Fill the radial sealing ring with grease between the sealing lip and the dust lip, then press in using special tool.

- 1c Pressure plate for radial sealing ring
- 4 Radial sealing ring

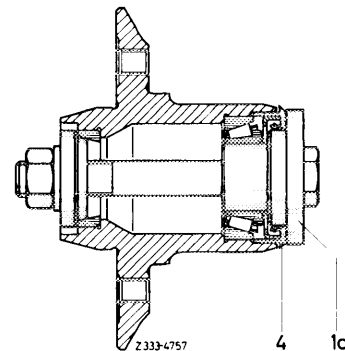

14 Fill the front wheel hub with the remaining grease.

**Note:** If too much grease is used, the filling action causes the grease to overheat and it can lose its lubricating properties. The amount of grease must however not be too small, otherwise the tapered roller bearings might not be properly lubricated.

15 Install the brake disc (42–220).

16 Check the condition of the running surface for the radial sealing ring on the steering knuckle.