

## Note

Adjust mechanical brake light switch (4) in such a manner that with the brake pedal (5) in inoperative position the contact button (6) of the switch should extend for approx. 6 – 8 mm from housing.

## Test Procedure

1 Measure distance „a” with brake pedal (5) in inoperative position (correct distance conforms to a brake pedal travel of 15 – 20 mm).

## Adjustment

2 Adjust brake light switch with the two hex. nuts (3) which are simultaneously serving to attach switch.

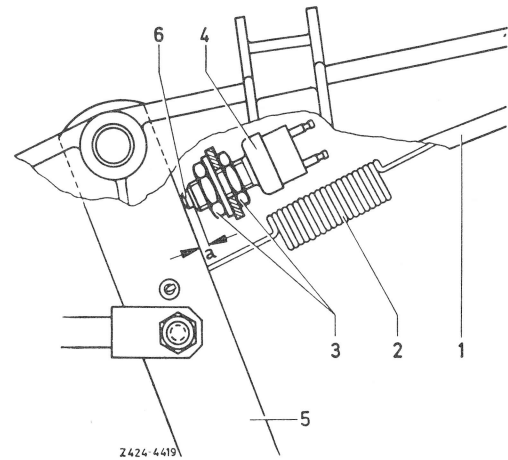

Fig. 1

a = 6 – 8 mm

- |                       |                      |
|-----------------------|----------------------|
| 1 Brake pedal carrier | 4 Brake light switch |
| 2 Return spring       | 5 Brake pedal        |
| 3 Hex. nut            | 6 Contact button     |