

**Data**

Model	Torsion bar		Rubber mounting of torsion bar bearing	
	Part No.	Diameter	Part No.	Bore dia.
107 323 01 65	25	972	114 323 05 85	23.5–0.5

1) Previous version (until February 72)

2) Present version (from March 72)

**Torsion Bar Connecting Linkage on Front Axle**

Part No.	Rubber buffer		Spacing tube Length	Hex. bolt	
	Height			Length	Length without threads
115 323 02 44	20		100	210	178–1.5

**Tightening Torque**

		Nm	(mkg)
Hex. bolts of torsion bar bearing	M 8	25	(2.5)

**Removal**

**1** Loosen connecting linkage left and right on lower control arm (Fig. 1).

**2** Unscrew holding bracket of torsion bar bearing left and right and remove torsion bar (Fig. 1).

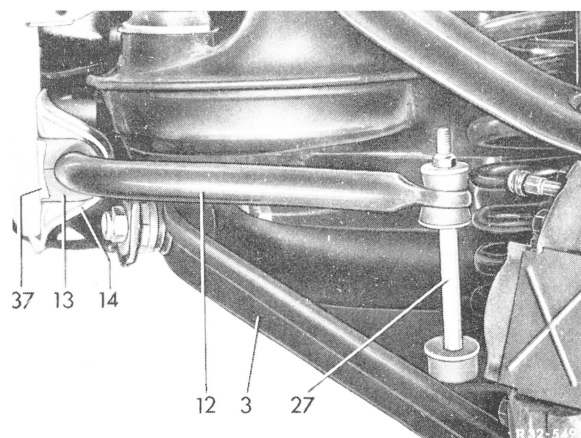

Fig. 1

- |                                    |                                     |
|------------------------------------|-------------------------------------|
| 3 Lower control arm                | 27 Torsion bar connecting linkage   |
| 12 Torsion bar                     | 37 Safety plate for rubber mounting |
| 13 Rubber mounting for torsion bar |                                     |
| 14 Holder for rubber mounting      |                                     |

**Installation**

**3** Check rubber mounting of torsion bar bearing and rubber rings of connecting linkage (Fig. 3).

**4** Slide rubber mounting on torsion bar with parting slot toward front, attach locking plate (37) and mount torsion bar bearing to frame floor (Fig. 2 and 3). Align torsion bar prior to tightening hex. bolts.

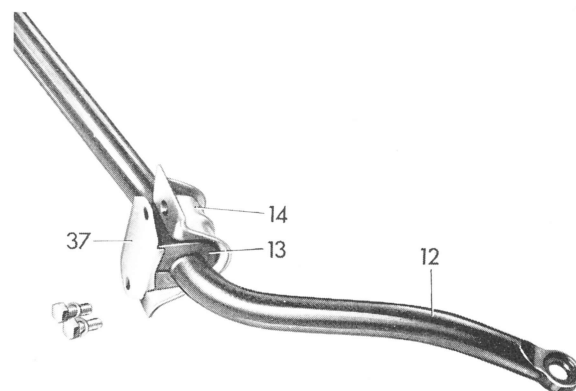

R-3646

Fig. 2

- |                    |                    |
|--------------------|--------------------|
| 12 Torsion bar     | 14 Holding bracket |
| 13 Rubber mounting | 37 Locking plate   |

## 32.1 Removal and Installation of Torsion Bar on Front Axle

**Note:** Insufficiently tightened hex. bolts of the holding bracket may result in knocking noises when driving on winding roads.

**5** Attach torsion bar connecting linkage left and right to lower control arm (Fig. 3). Tighten hex. nut up to end of threads.

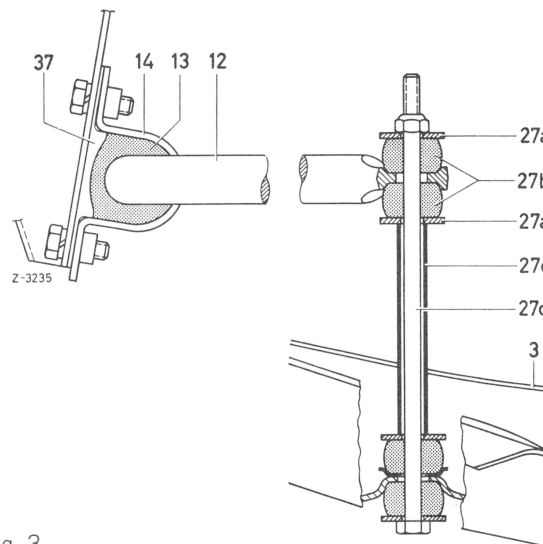

Fig. 3

3 Lower control arm  
12 Torsion bar  
13 Rubber mount  
14 Holding bracket  
27 Connecting linkage

27a Washer  
27b Rubber ring  
27c Spacing tube  
27d Hex. bolt  
37 Locking plate