

47-110 Removal and installation of fuel expansion tank

Model 107.04

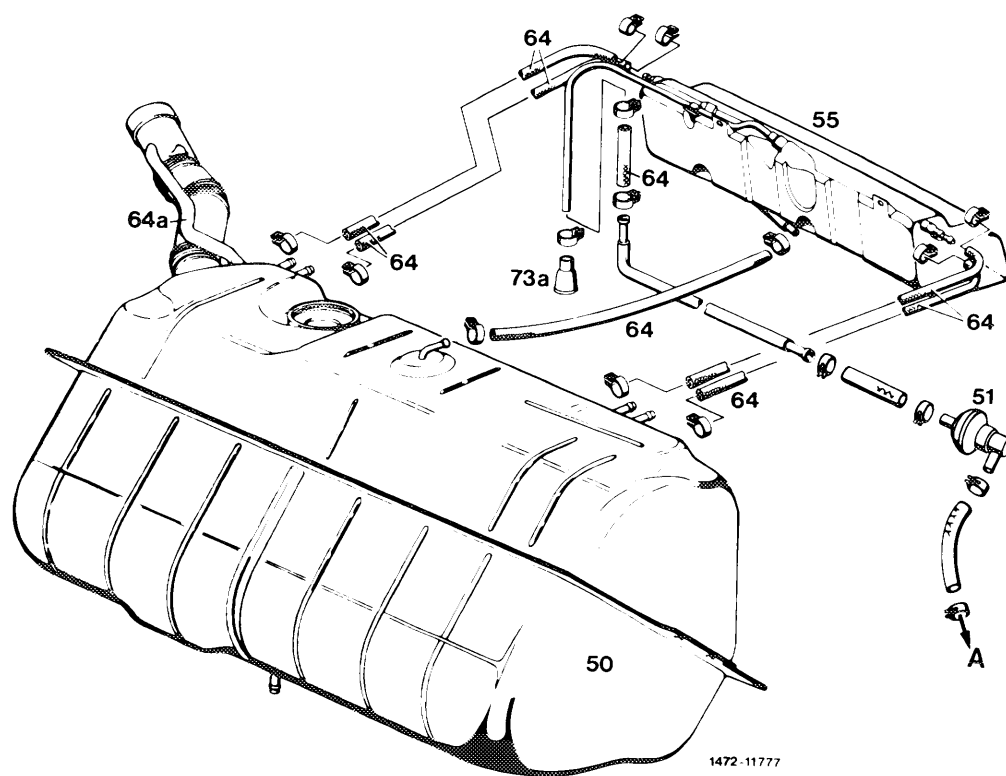

- 50 Fuel tank
- 51 Vent valve (AUS) (J) (USA) and CAT/RÜF
- 55 Expansion tank
- 64 Vent lines
- 64a Negative vent line
- 73a Protective sleeve
- A To charcoal canister (AUS) (J) (USA) and CAT/RÜF

Removal

1 Remove hard top. Unlock top locks and remove top.

2 Remove trunk floor mat.

3 Unscrew fastening screw (arrow) for expansion tank. On vehicles starting November 1982, loosen lining of partition in upper range to the extent that the fastening screw is accessible.

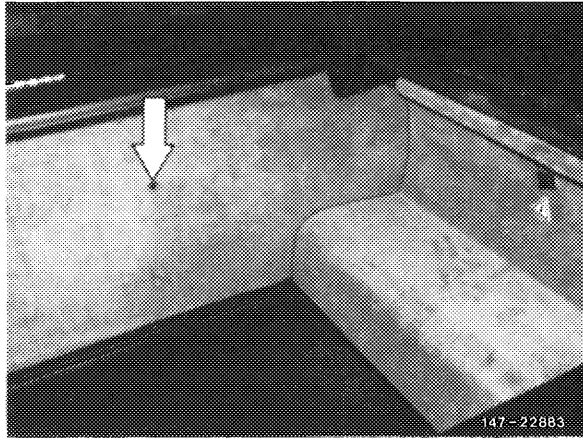

4 Unscrew partition and remove. For this purpose, loosen lining in range of edge at top and laterally, on vehicles starting November 1982 at top and bottom, and unscrew fastening screws (arrows).

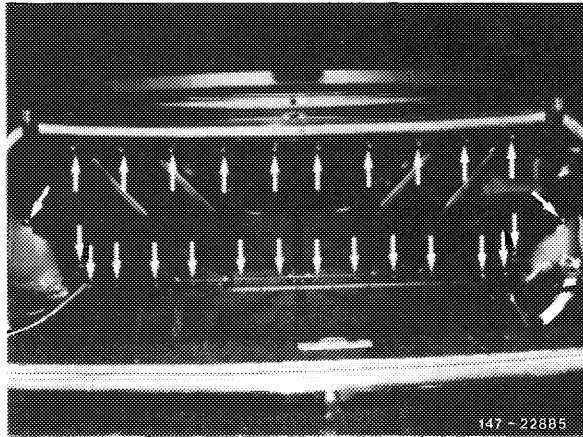

5 On vehicles with battery in trunk, remove battery and battery lining (arrows).

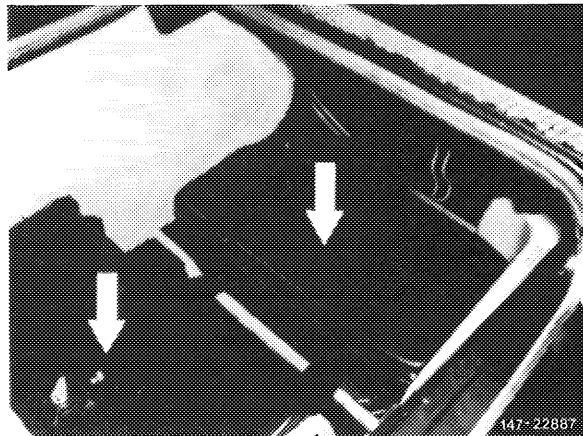

6 Remove protective sleeve (arrow) and unclip vent line from holding clamp.

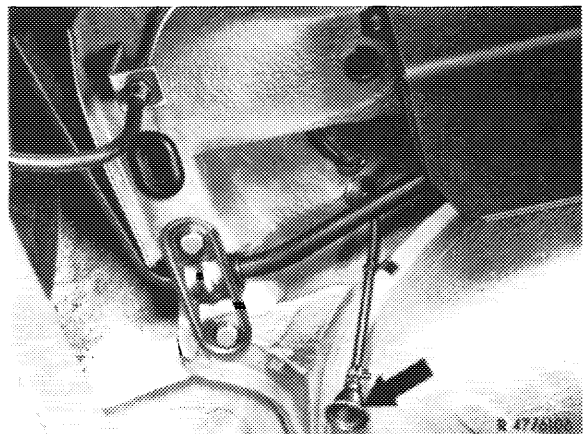

7 On vehicles with fuel evaporation control system, pull fuel hose (arrow) from vent line.

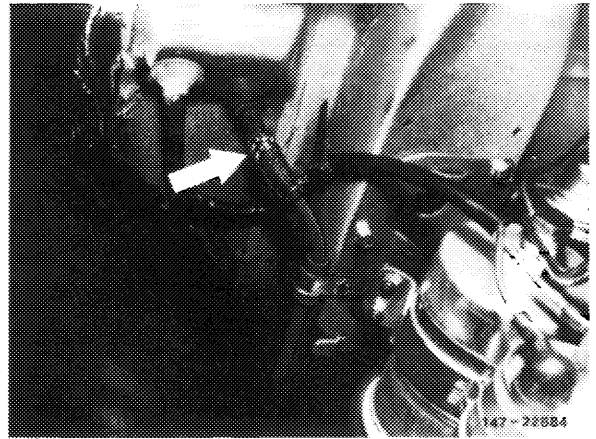

8 Remove vent lines on fuel tank or on expansion tank. Check for re-use.

Note: If fuel hoses are removed on or mounted from expansion tank, apply counterhold to connections on expansion tank when loosening or tightening hose clamps (risk of breaking off).

50 Fuel tank
55 Expansion tank
64 Vent lines

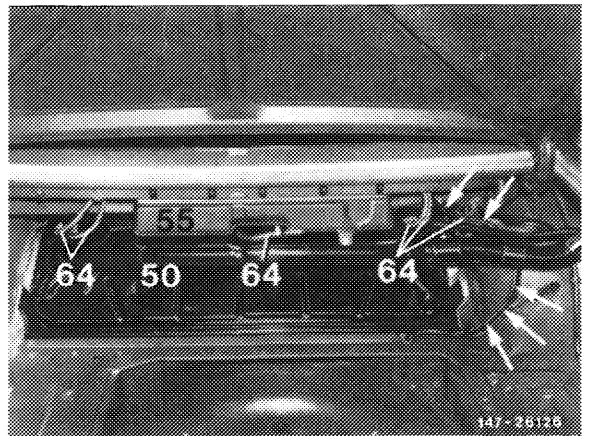

9 Unscrew fastening screws (arrows) and remove expansion tank (55), while pulling out black vent line (64, arrows) through trunk floor in upward direction.

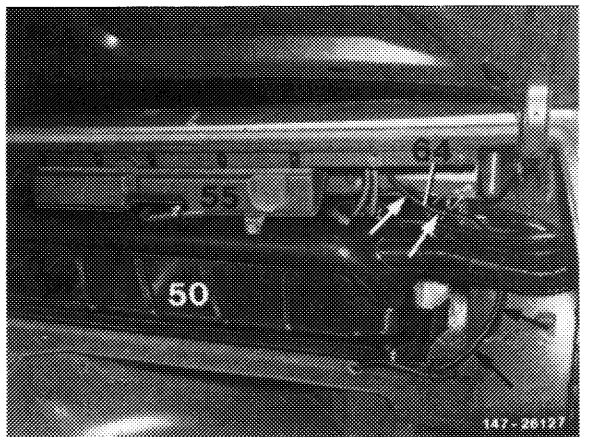
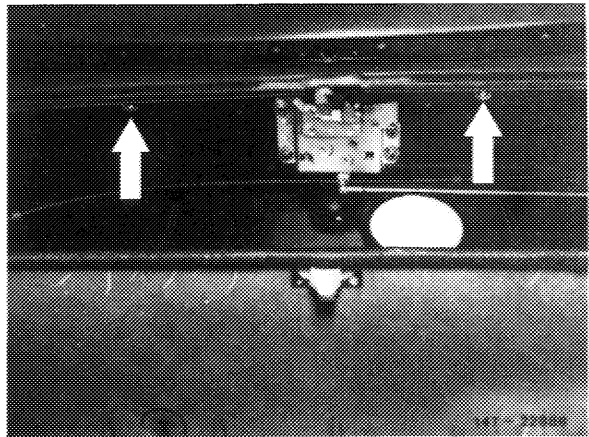

Installation

10 For installation proceed vice versa as follows:

a) Install vent line (64, arrows) first behind filler neck of fuel tank.

b) The spare parts department supplies now only the lining without opening for fastening screw (1). Glue on lining at top and bottom each time approx. 100 mm wide across entire width of partition with universal glue, part No. 000 989 82 71.

Note: Check fuel system for leaks.

